

P.C.B mounting hole detail

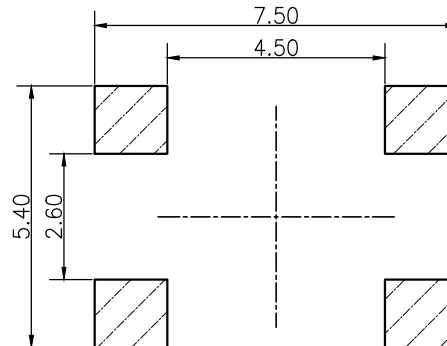

1. Material list

ITEM	DESCRIPTION	MATERIAL
1	Cover	SUS
2	Dome	SUS301
3	Knob	75° ±5° high temperature Silica gel
4	Base	Nylon
5	Terminal	Copper alloy

Electrical Life	5,000,000 cycles
Mechanical Life	5,000,000 cycles
Pre Travel	0.2mm min
Operating Force	95±15gf (10gf分BIN)
Release Force	25gf Min.
CCP	15% Min.

CIRCUIT

