

(Tolerance: ± 0.1)
(P.C.B thickness $t=1.6$)

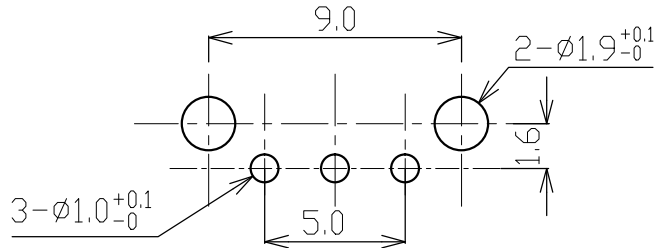

1. Material list

ITEM	DESCRIPTION	MATERIAL
1	Cover	SPCC
2	Anchor Plate	SUS301
3	Wheel gear	POM
4	Base	PA66
5	Terminal	C5191

Rating	5VDC 100mA
Endurance	1,000,000 cycles
Rotational Force	20±6gf.cm

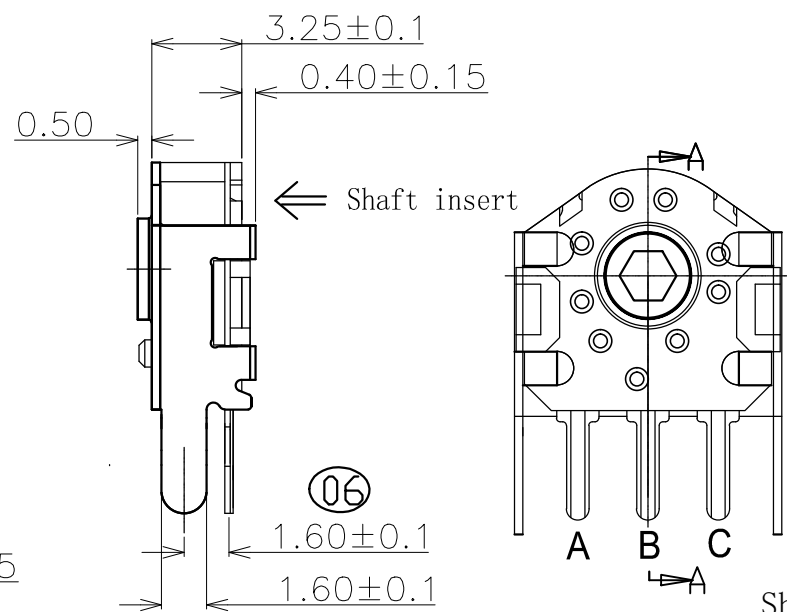
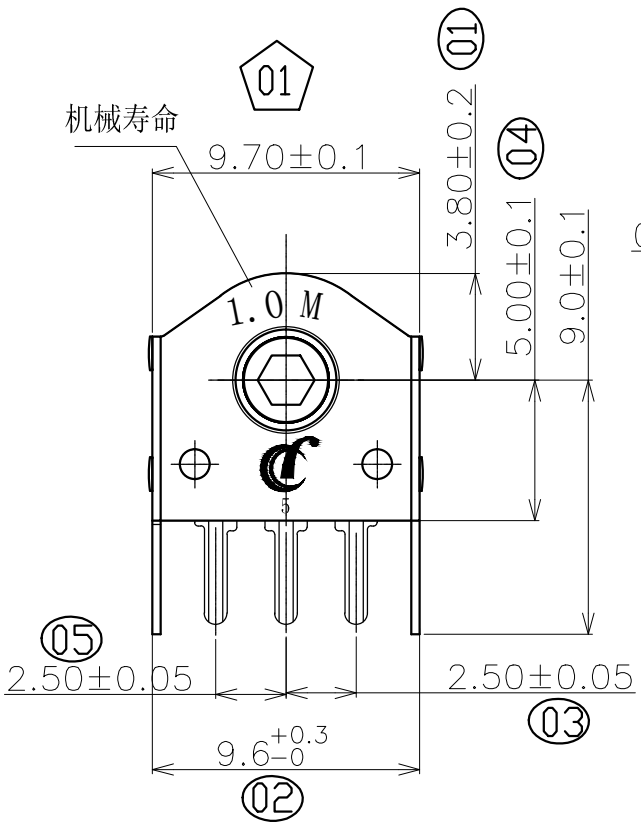

← Shaft insert

Shaft hole shape and dimension

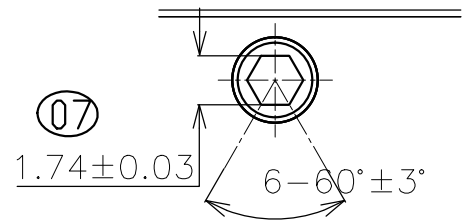

Shaft hole position will be at random

